

ABBYY Timeline

Abby Vantage and Timeline Connector

Developed By: Tanvi Sharma

Table of Contents

About the ABBYY Timeline Connector	3
System Requirements	3
Setting up the connector	3
Importing the package	3
Generating Personal Access Token.....	4
Using the connector	5

About the ABBYY Timeline Connector

ABBYY Timeline is a process intelligence platform that leverages artificial intelligence and machine learning to provide detailed insights into business processes.

The ABBYY Timeline Connector for ABBYY Vantage links document processing with process intelligence. It lets organizations automatically send data from Vantage to Timeline for process mining, visualization, and analysis. This helps spot inefficiencies, bottlenecks, and patterns, making it easier to optimize workflows. The connector also supports real-time monitoring and predictions, providing insights for better decisions. With this integration, businesses can continuously improve processes while boosting accuracy, speed, and compliance.

System Requirements

To use the Timeline Connector, your Timeline account must have one of the following roles:

- Data Manager
- Administrator
- Project Owner

Additionally, the Timeline API data source must be enabled for the target project; otherwise, API requests will fail. Ensure you also have an active ABBYY Vantage account.

Setting up the connector

To set up the connector, perform the following steps:

Importing the package

The connector package includes a process skill:

- Abbyy_Timeline_Connector.zip—Process which sends data extracted by Vantage to Timeline.

To import the package, do the following:

1. Download the “Abbyy Timeline Connector.zip” package.
2. Click Import, then Import Package.

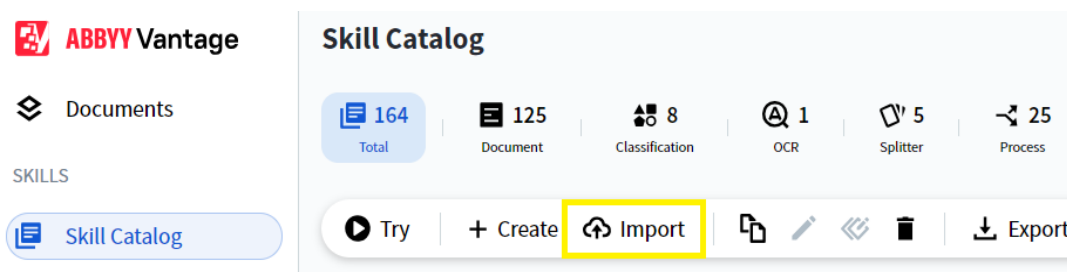

3. Select the downloaded ZIP package.
4. Click **Open**.

- Once the Skill is imported, the “Abby Timeline Connector.zip” process skill is available under the Process Skill tab.

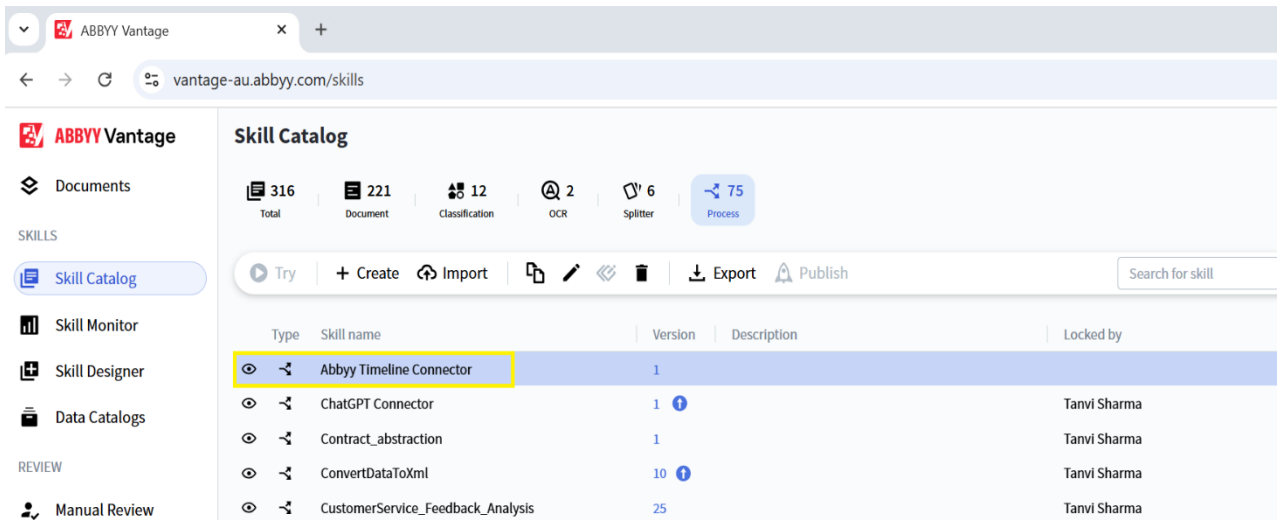

Generating Personal Access Token

To connect to Timeline, you need to generate a personal access token and provide write permissions for project and repositories.

To generate a personal access token, follow the below steps:

- In your Timeline Account navigate to “User Profile”.
- Under “User Profile” navigate to “Personal Access Tokens”.
- Create a new personal access tokens and set the configurations such as name, token expiration and permissions.
- Under permissions you can grant different levels of permissions for project, repository and profile.

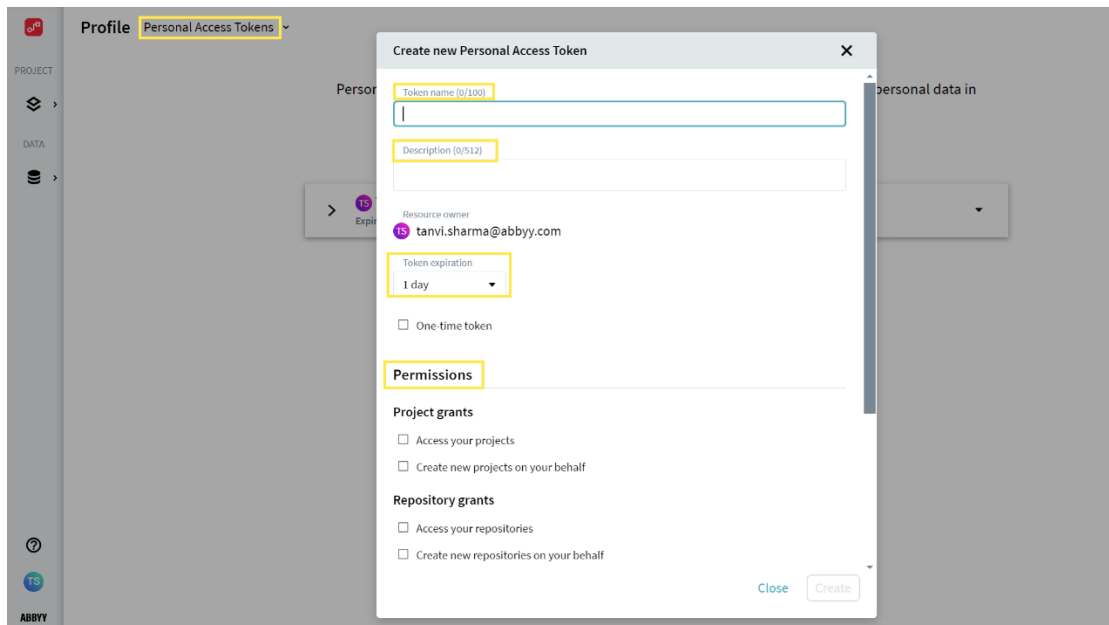

- Once the personal access token is created copy and save the token as it would be visible only once.

- 6. Copy the generated personal access token and directly save this value to ABBYY Vantage environment variable (Timeline_Personal_Access_Token).

Using the connector

To use the Timeline connector setup the below values in Vantage process skill(package) downloaded.

- Create the below environment variables and set the value:
 - Timeline_Base_URL :- Timeline Base URL
 - Timeline_Personal_Access_Token :- Timeline Personal Access Token generated in previous step.
 - Timeline_Project_ID :- The timeline project id in which you want to send the data. This can be found in the URL of your timeline project as highlighted in the below screenshot.

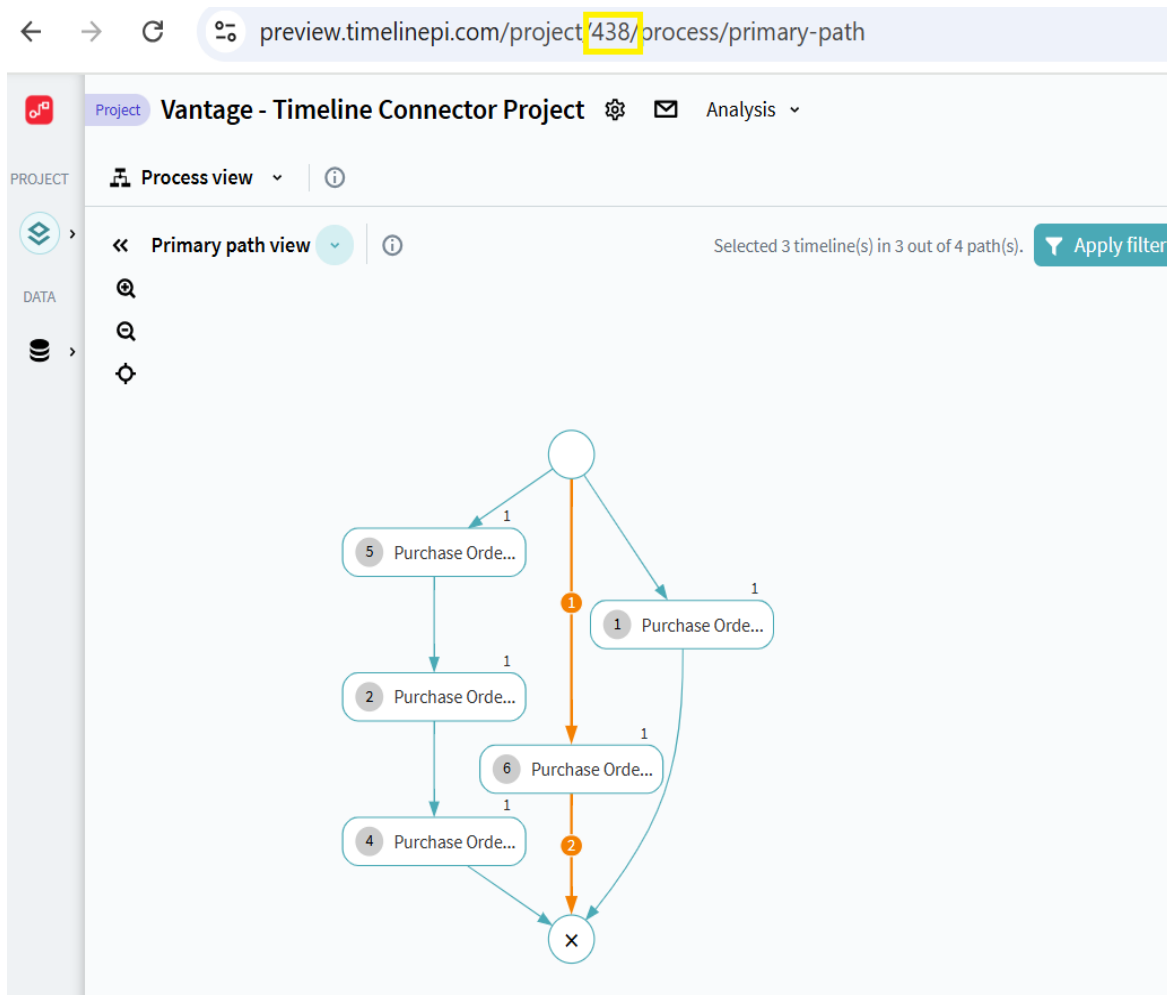

- The script to send data to ABBYY Timeline is implemented in the "Output" activity of the Vantage process skill.

- After setting up the environment variables in the output activity, map the fields to the respective columns in ABBYY Timeline to ensure accurate data transfer.

Output Settings: External System

Configure Export to external system

Determine an algorithm to export transaction data to an external system. This may transform the transaction data and send it using an HTTP request. See the documentation for more info. [View Documentation](#)

Functions ▾ | IF = > < AND OR NOT FOR WHILE

```

69 request.AuthScheme = "Bearer";
70
71 request.SetHeader("Content-Type", "application/json; charset=utf-8");
72 request.AuthToken = timeline_access_token;
73 const requestData = {
74   fileKeys: [key],
75   mapping: { //Mapping fields with timeline parameters
76     event_id: {
77       title: 'Purchase Order',
78       type: 'String'
79     },
80     timeline_id: {
81       title: 'Invoice Number',
82       type: 'String'
83     },
84     timestamp: {
85       title: 'Invoice Date',
86       type: 'Date'
87     },
88     attributes: [
89       {
90         title: 'Currency',
91         type: 'String',
92       },
93       {
94         title: 'Total',
95         type: 'Number',
96       },
97     ]
98   }
99 }

```

- Process the document in Vantage. Once it completes all stages, the "Output" activity script will send the data to ABBYY Timeline for visualization and analysis.
- Logs are added for testing to track data flow and debug issues. These can be removed later for optimal performance.